

SPEC LADAR FAMILY

Multi-Dimensional Imaging

SPEC LADAR Advantages:

- Extremely high pixel per second rate, 16Mpps, 2Mpps for micro
- Long eye-safe range Gen IV 10km 0.1 reflective target
- High range accuracy, 5mm close range out to 30% range rising to 25mm at acquisition range
- SWAPc, Gen IV is 3.5dia x 8.5 smallest form, micro LADAR is 3in³
- Raman Spectral LADAR can discriminate surface chemical composition

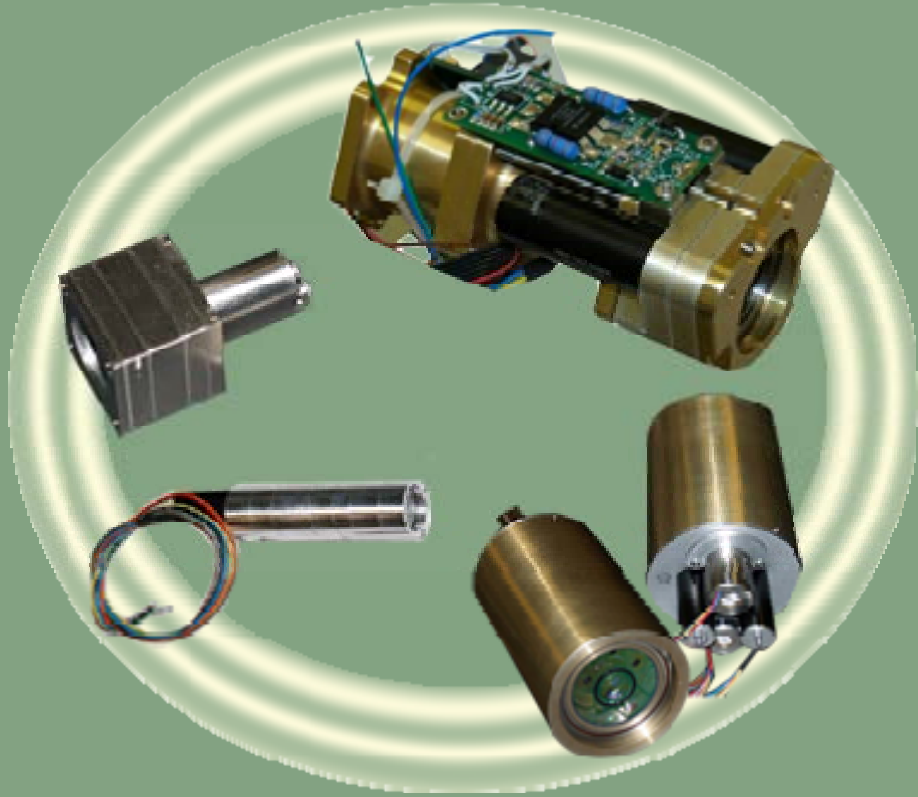

Uses:

- Navigation and target discrimination for small UGV, UAV, guided munitions and satellites
- Resource management and animal counting under forest canopy
- Imaging during brown-out landings in helicopters
- Raman Spectral LADAR can be used for explosive detection and discriminating target surface chemistry

Scanner/Telescope Family

- Risley Prism Scanners
- Cassegrain Receive Telescope
- Coaxial Laser Collimator



ISL LADAR
18mm aperture

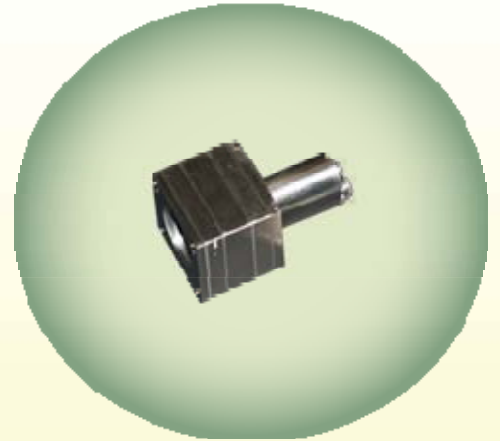

Micro LADAR
10mm aperture

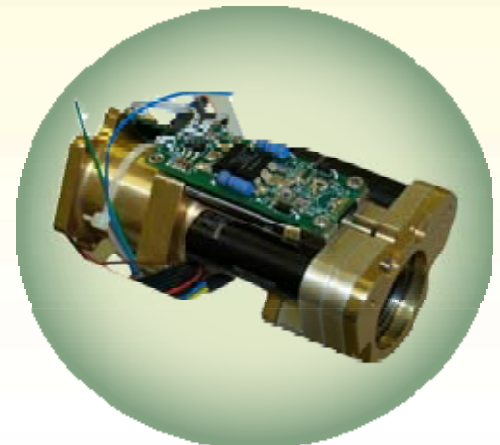

GEN I LADAR
25mm aperture



GEN IV LADAR
50mm aperture